



# Yanmar type 6BY260Z

## The Powerful Gem



<b>Configuration</b>	In line, 4-stroke cycle, water cooled diesel engine
<b>Maximum output at crankshaft *</b>	191 kW ( 260 mhp) / 4000 rpm
<b>Continuous rating output at crankshaft</b>	147 kW (198 mhp) 3600 rpm
<b>Displacement</b>	2.993 L (183 cu in)
<b>Bore x stroke</b>	84 mm x 90 mm (3.31 in x 3.54 in)
<b>Cylinders</b>	6, Common Rail with vertical injectors
<b>Combustion system</b>	Direct injection
<b>Aspiration</b>	Wastegated, turbocharged with intercooler
<b>Starting system</b>	Electric starting 12 V - 2 kW
<b>Alternator</b>	12 V - 150 A
<b>Cooling system</b>	Fresh water cooling with heat exchanger, and sea water cooled charge air cooler
<b>Lubrication system</b>	Totally enclosed, forced lubricating system with pump
<b>Can Bus</b>	Device net according to NMEA 2000 protocol
<b>Direction of rotation (crankshaft)</b>	Counter clockwise viewed from stern
<b>Dry weight without sterndrive</b>	310 kg (683 lbs)
<b>Environmental</b>	EPA Tier 2, RCD, SAV, BSO. Meets the EU comprehensive emissions regulation 2006
<b>Engine mounting</b>	Rubber type antivibration mounts

NOTE: Fuel condition: Density at 15°C = 0.84 g/cm<sup>3</sup>; 1kW = 1.3596 mhp = 1.3410 HP

\* Fuel temperature 40°C at the inlet of the fuel injection pump (ISO 8665)

Technical data is according to ISO 8665 / 3046

**Dimensions** (For detailed line-drawings, please refer to our web-site: [www.yanmarmarine.com](http://www.yanmarmarine.com) or contact your supplier)

### Front view

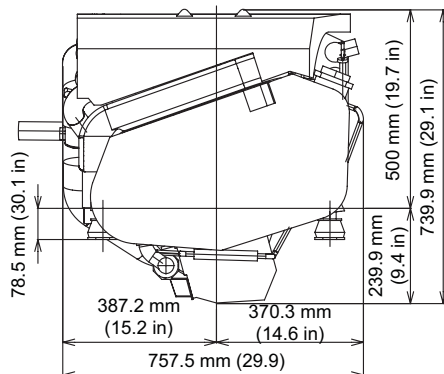

### Right side view

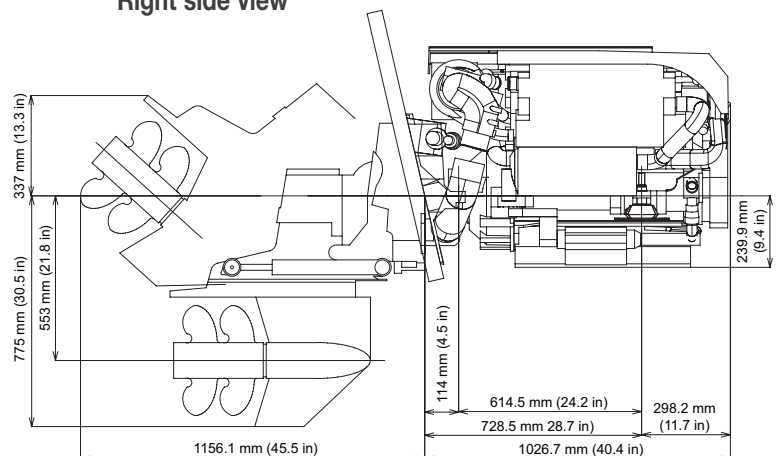

6BY260Z w/ BravoX-3 Sterndrive

## Performance Curves (Output is according ISO 8665)

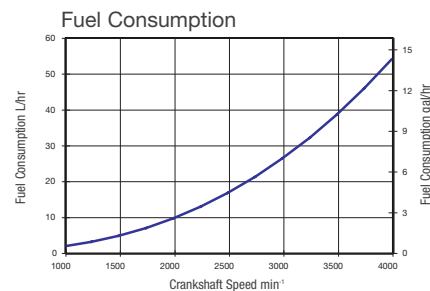
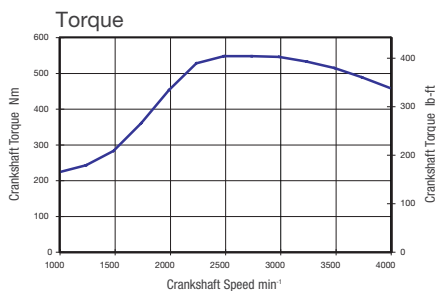
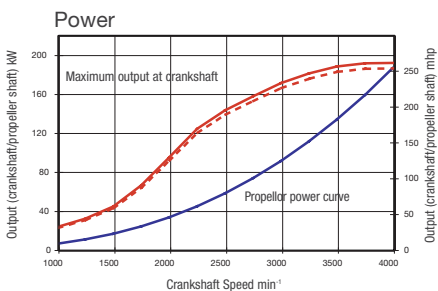

## Yanmar & Mercruiser sterndrive set Engine

Model	"Mercruiser" Bravo Sterndrive series			
Type	Bravo X-3			
Dry weight	98 kg (216 lbs)			
Reduction ratio (fwd/asn)	1,36/1,36	1,50/1,50	1,65/1,65	1,81/1,81
Propeller speed (fwd/asn)	2941/2941	2667/2667	2424/2424	2210/2210
Direction of rotation (propeller shaft - fwd)	Clockwise & counter clockwise viewed from stern			
Dry weight engine with sterndrive	408 kg (899 lbs)			
Length engine without sterndrive	1027 mm (40 in)			

1, Inner and outer transom surface must be parallel within 3mm in area covered by transom plates and remain within transom thickness limits.

2, Area covered by gimbal housing assembly must be flat to within 1.6mm.

3, Area covered by inner transom plate must be flat to within 3.2mm

4, Transom angle: 13° to 16°

5, Also available with: BravoX-1 and BravoX-2. Contact your local supplier for available configurations

## Instrument Panels

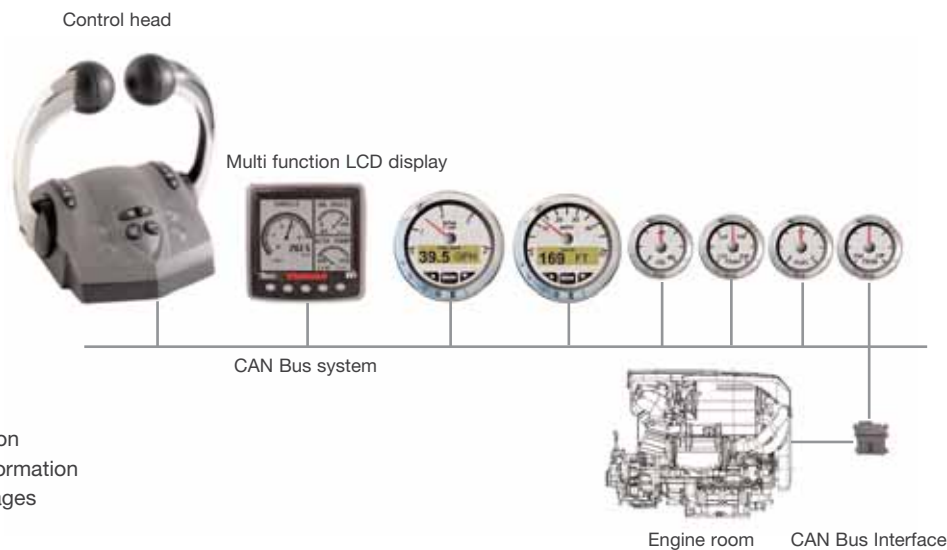

Multi function LCD display:

- engine information
- maintenance information
- diagnosis messages

## Accessories

### Standard Package

- Set of flexible mounts
- Alternator 12 V - 150 A single pole (24V is not available)
- Engine top and belt cover

- Exhaust mixing elbow (L-type)

### Optional

- High riser mixing elbow
- Exhaust side dipstick
- Glow plug controller and related parts

- Dual top mount Teleflex control head (throttle position sensor included)
- Teleflex CAN single and double top mount control heads
- Teleflex interface module for analogue sensors (engine oil pressure, fuel tank level, etc)
- Various gauges